

Series GMPD

Motor type 406188

Design Data	
Commutation	Brushed
Direction of rotation	Bi-directional
Bearing type	A:Ball - B:Sleeve

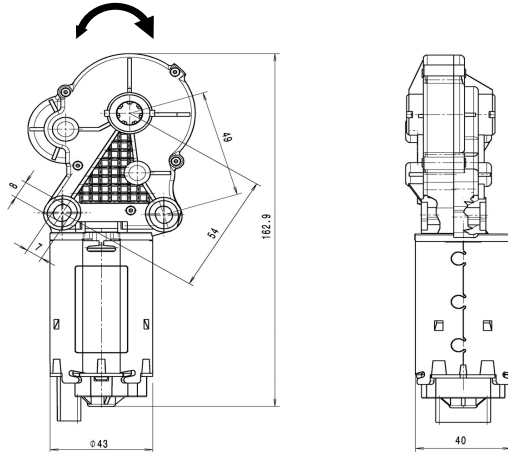

Motor picture



Performance data		
Rated voltage [V]	U_N	12V
Nominal torque [Nm]	M_N	23
No-load speed [min ⁻¹]	n_0	24
Nominal power [W]	P_N	45
Nominal current [A]	I_N	3,8
Nominal force [kN]	F_N	0.00
Duty cycle	s1	

Sensor data	
Pulses	0
Output channels	0

Other data	
Gear ratio	210:1
Gear wheel material	
Suppression components	5 μ H, 10nF
Enclosure class	IP 30
Weight [kg]	1.150

Remarks:

Characteristic curves

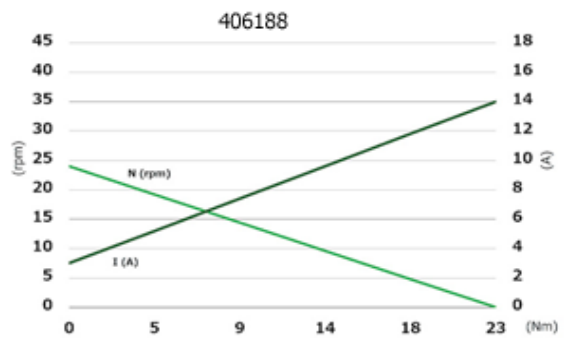

Output shaft drawing (W)

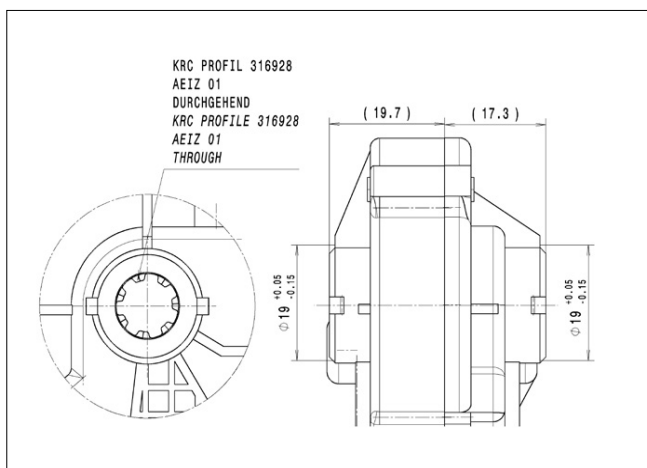

Connector layout (K)

