



Torque Range

3.000 ... 75.000 Nm

Truck mixer capacity

1 to 12 cubic meters

Gear Ratios

17 ... 161

Key Features

- Rotating housing flange
- Rugged design
- High torque capacity
- High load capacity
- Tilting output flange, evenly in all directions
- Mounting frame for water tank
- Water pump P.T.O.
- Speed sensor.

Applicable hydraulic motors

Axial piston motors to SAE Standard orbit motors

Type	Max. Torque Nm	Range of ratios 1:	Hydraulic motor drive (1)	Max. input speed min ⁻¹	Drum capacity (2)	Weight Kg	Oil quantity l	Design	Water pump P.T.O.	Speed sensor
501	3000	17-23-29	LS	550	0,5 - 1	45	1.5	A	—	—
564	12000	78-161	HS	2500	2 - 3	85	2	A	—	—
565	12000	22	LS	550	2 - 3	70	1.5	A	—	—
567	20000	76-90-115-128	HS	2500	4 - 5	140	3	A	—	—
568	20000	18-21-27	LS	550	4 - 5	130	2.5	A	—	—
575	50000	100	HS	3000	6 - 8	250	7	B	•	•
577	60000	131	HS	3000	8 - 10	290	8.5	B	•	•
580	75000	130-147	HS	3000	10 - 12	320	10	B	•	•

(1) LS = Low speed motor, HS = High speed motor

(2) General indication, application capacity depend on concrete slump

— = Not available

• = Available

DESIGN A

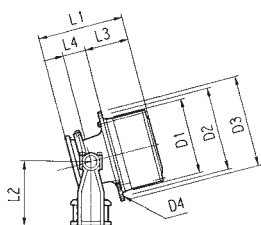

DESIGN B

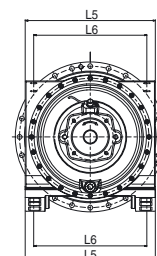
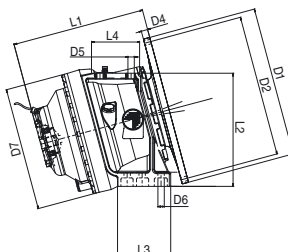

Type	Dimensions													
	D1	D2	D3	D4	D5	D6	D7	L1	L2	L3	L4	L5	L6	
501	200	222	245	13 N° 4				270	195	138	89			
564	280	310	340	17 N° 10				365	240	165	85			
565	280	310	340	17 N° 10				290	240	165	85			
567	358	390	430	17 N° 18				435	300	210	110			
568	358	390	430	17 N° 18				360	300	210	110			
575	530	500		17 N° 24	22 N° 4	22 N° 6	435	450	400	188	170	460	400	
577	530	500		17 N° 24	22 N° 4	22 N° 6	435	450	400	188	170	460	400	
580	530	500		17 N° 24	22 N° 4	22 N° 6	435	525	400	188	170	460	400	

HEADQUARTERS

BONFIGLIOLI RIDUTTORI
Via Giovanni XXIII, 7/A
40012 Lippo di Calderara di Reno
Bologna (ITALY)
Tel. (+39) 051 6473111
Fax (+39) 051 6473126
www.bonfiglioli.com

SALES DEPARTMENT

BONFIGLIOLI RIDUTTORI S.p.A.
Via Enrico Mattei, 12 - Z.I. Villa Selva
47100 Forlì (ITALY)
Tel. (+39) 0543 789111
Fax (+39) 0543 789242 - 0543 789245
trasmital@bonfiglioli.com



BONFIGLIOLI