

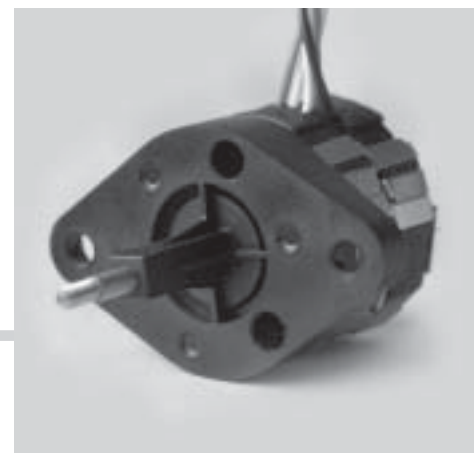

Motor Series **MTS3L**

Linear Stepper Actuator - 0.033/0.0417/step



Technical Data

| | | | | | |
|------------------------|----------|--|------|-----|-----|
| Steps per revolution | | 24 | | | |
| Winding Type | | bipolar | | | |
| Rated Voltage | V | 3 | 6 | 12 | 24 |
| Resistance per winding | Ω | 11.5 | 18.5 | 100 | 460 |
| Winding Type | | unipolar | | | |
| Rated Voltage | V | 3 | 6 | 12 | 24 |
| Resistance per winding | Ω | 12 | 28.5 | 120 | 500 |
| Axial Force | kg | 1.0 (can be increased for special winding) | | | |
| Max force | kg | 3.5 | | | |
| Travel per step | mm | 0.033/0.041 | | | |
| Travel speed by 200Hz | mm/s | 8, 13 mm (other on request) | | | |
| | | 6.67/8.33 | | | |

Drawing

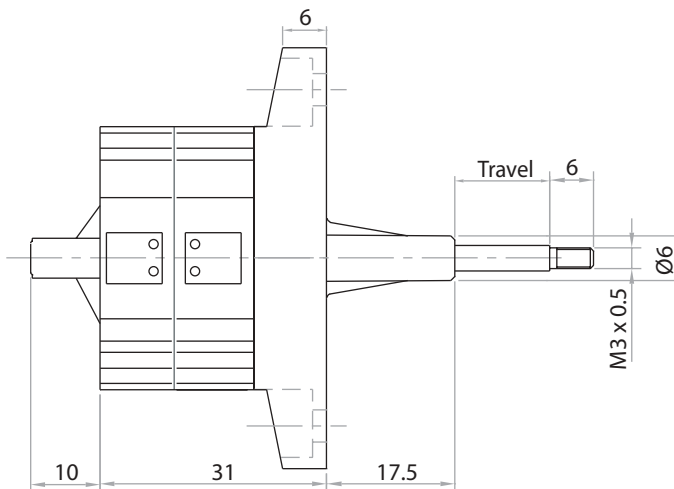
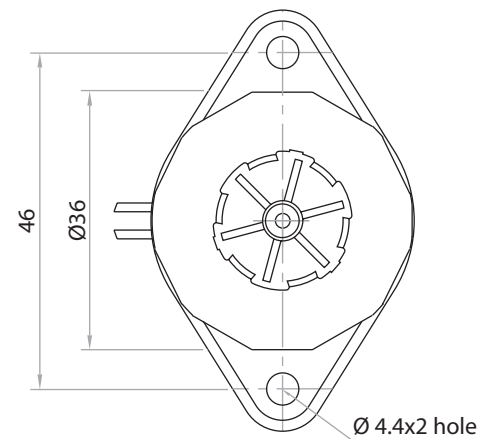
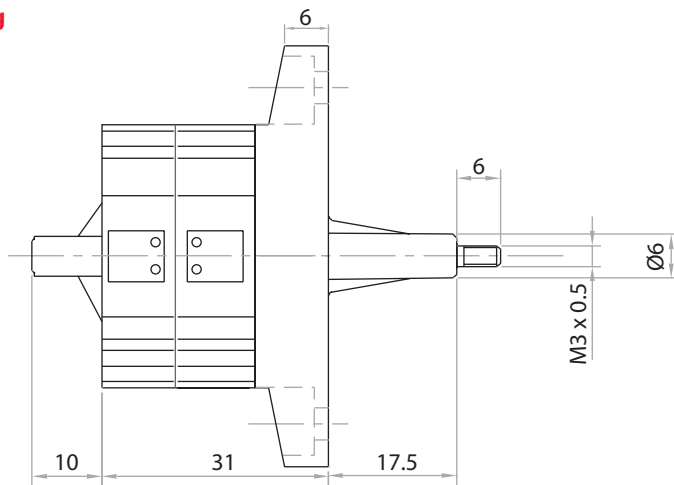

Ordering Data (eg.)

13M C D3 P R

- Direction -Reversible
- Mounting -with mounting plate
- Voltage - 6 V DC
- Approval - CE marked
- Motor -MTS3L (unipolar)