



Gear Series **GB7**

Spur Reduction Gearhead - 50 Kg-cm



Design

Gearhead GB7 contains heavily loaded steel gear wheels. The spur gears rotate on fixed steel spindles which are hardened and polished to a mirror finish. The thick output shaft rotates in robust sintered bushings. All the gears are housed in a pressure die cast housing & closed by metal plates. All bearings are permanently lubricated and therefore require no maintenance. Economical versions with poly-acetal or sintered gears available. This gear box can also be combined with small to medium sizes of DC motors. Output shaft can be emerging from the rear side or both sides. Potentiometer can be mounted on to the gearhead & connected to the output shaft by means of a gear ratio (standard = 1:1; others possible). Instead of rotational, linear drive also possible (on demand only). GB7 can also be coupled with small DC motors (up to Ø36mm).

Standard Data

Gear Torque	kg-cm	50
Combination with Mechtex motors		MT0, MT6, MTR/S5, MTR/S-4a/b, MTR/SD-4, MTR/SD4-RE & DC motors / (upto Ø40)
Mounting		any position
Weight	gm	300
Axial thrust	kg	10
Radial torque	kg	40
Lateral torque	kg-cm	40
Slipping clutches/free wheel		available for certain ratios
Output bearing		Sintered Bronze
Output shafts	Ø	dia. 8 x 17 mm (with a flat), others on request
Ambient temperature operation	°C	-15...+55

Torque/Transmission ratio/life Graph

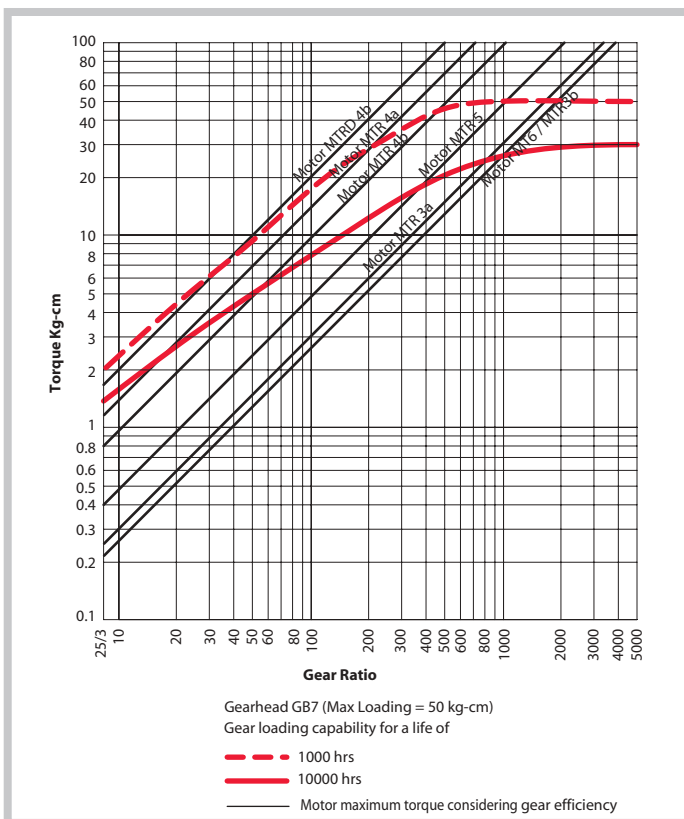

Transmission ratios

For Transmission Ratios refer to page nos. 12 & 13.

Dimensional Drawing

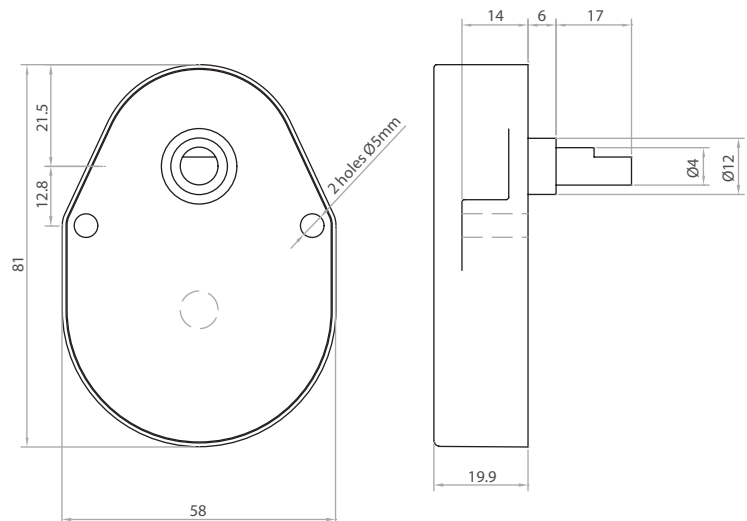



Gear Series GB7

Spur Reduction Gearhead - 50 Kg-cm

Shaft Drawings

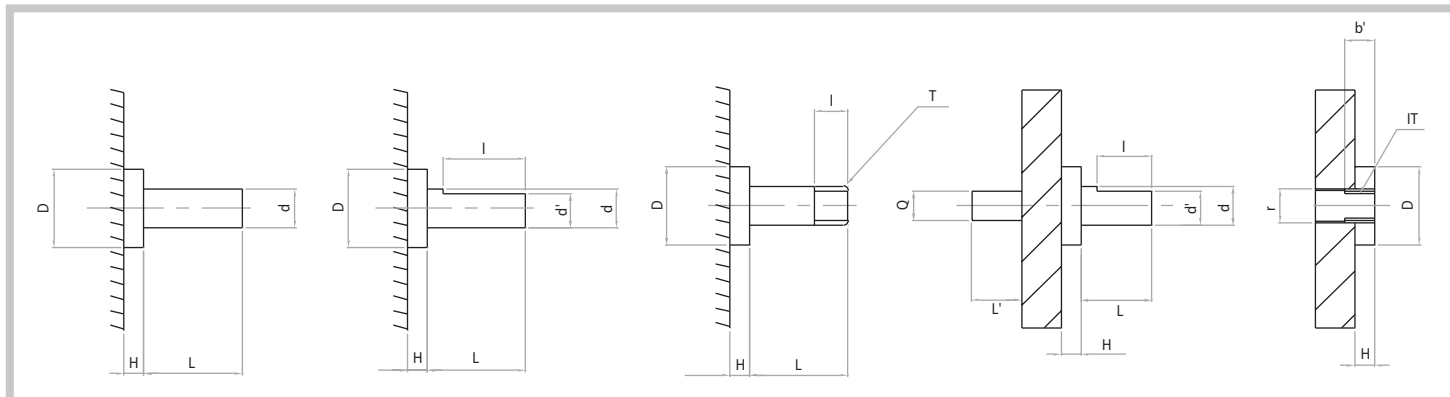

Shaft Type Catalogue

Shaft type Catalogue	D	H	d	Shaft Diam. L	l	d'	L'	Q	T	b'	r	IT
S	12	6	8	16	8	6						
A	12	6	8	26	18	6						
B	12	6	8	18	8	6	12.5	6.35				
C	12	6	6.5	16	8	5.5						
D	12	6	6.5	26	18	6						
E	12	6	6.5	16	8	5.5						
F	12	6	6.5	26	18	6						
G	12	6	8	17	10				M6x1			
H	12	6								7	6.2	M6x1

Drawings

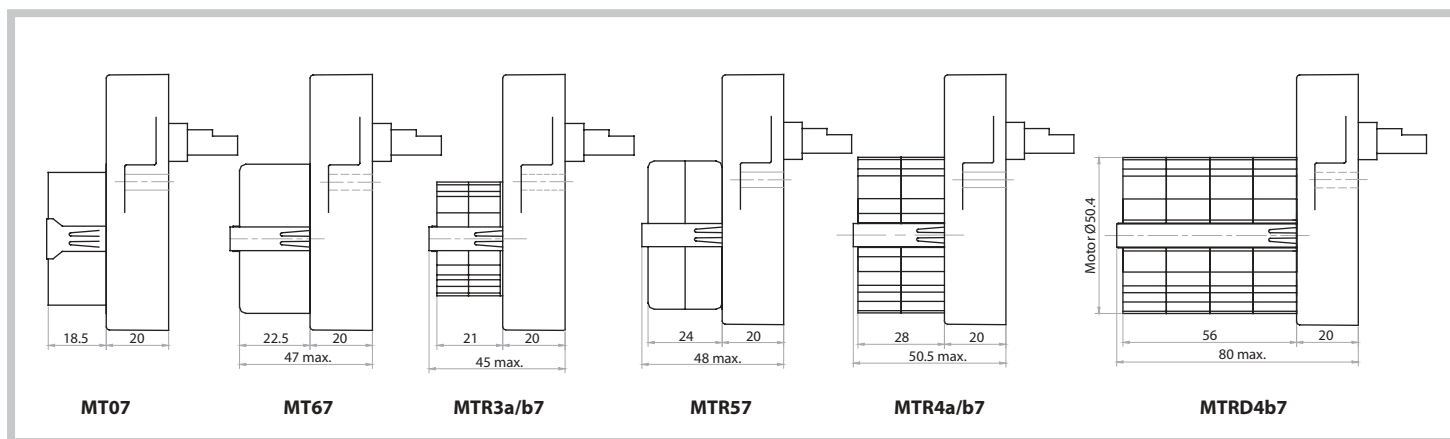

Photographs

