



Gear Series **GB4**

Spur Reduction Gearhead -100 Kg-cm



Design

Gearhead GB4 contains heavily loaded steel gear wheels. The spur gears rotate on fixed steel spindles which are hardened and polished to a mirror finish. The thick output shaft rotates in robust sintered bushings. It can also be mounted on a ball bearing which can be provided in the output bush of the gear box. All the gears are housed between two metal plates with a plastic frame. All bearings are permanently lubricated and therefore require no maintenance. Economical versions with poly-acetal or sintered gears available. This gear box can also be combined with small to medium sizes of DC motors. Linear drives also possible with medium sized motors ($\varnothing < 40\text{mm}$).

Standard Data

Gear Torque	kg-cm	100 (Gear Torque can be increased to 200 kg-cm on request)
Combination with Mechtex motors		MT0,MT6,MTR/S3a/3b,MTR/S-5,MTR/S4a/4b and small DC motors / (upto $\varnothing 40$)
Mounting		any position
Weight	gm	350
Axial thrust	kg	10
Radial torque	kg	80
Lateral torque	kg-cm	80
Slipping clutches/free wheel		available for certain ratios
Output bearing		Sintered Bronze, Ball Bearing on request
Output shafts	\varnothing	dia. 8 x 18 mm (with a flat), others on request
Ambient temperature operation	$^{\circ}\text{C}$	-15...+55

Torque/Transmission ratio/life Graph

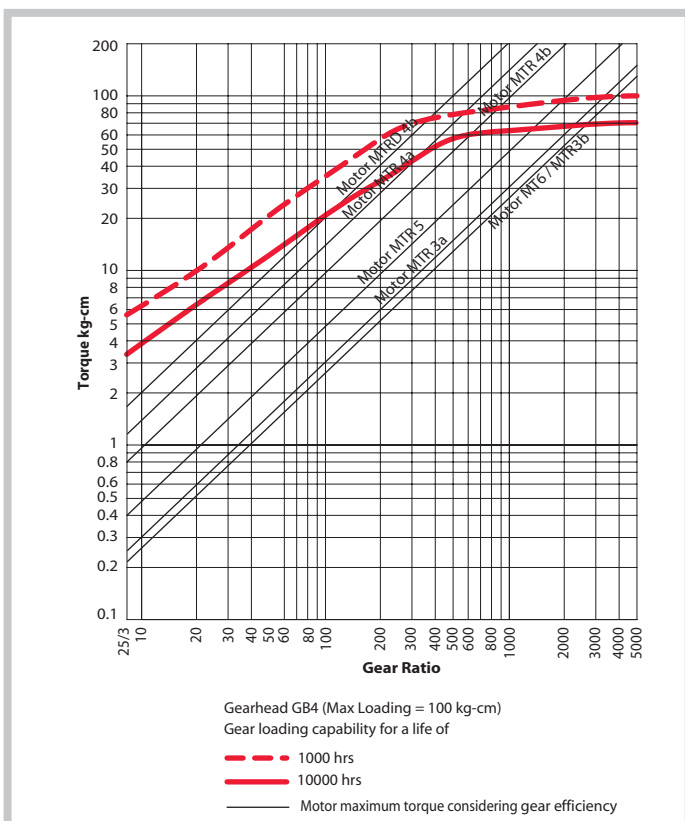

Transmission ratios

For Transmission Ratios refer to page nos. 12 & 13.

Dimensional Drawing

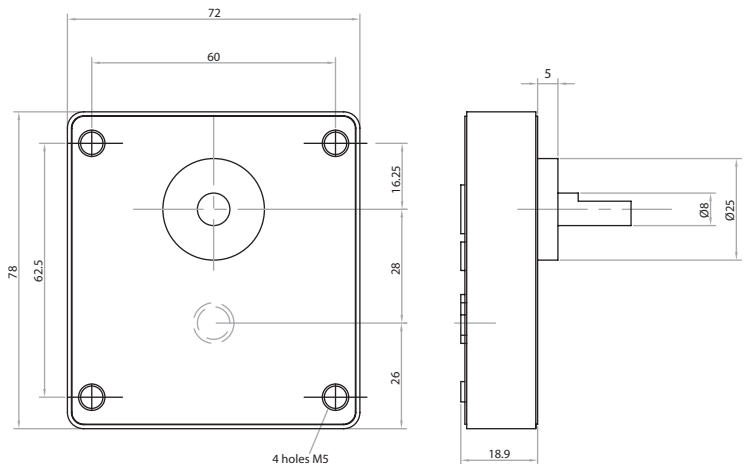



Gear Series GB4

Spur Reduction Gearhead - 100 Kg-cm

Shaft Drawings

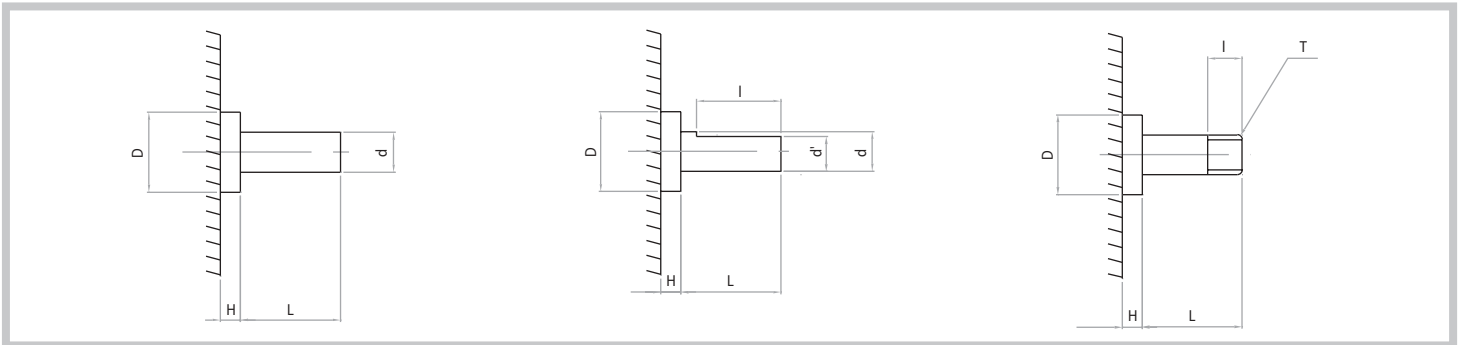

Shaft Type Catalogue

Shaft type Catalogue	D	H	d	Shaft Diam. L	I	d'
S	25	5	8	16	8	6
A	25	5	8	26	18	6
B	25	5	6.5	16	8	5.5
C	25	5	6.5	26	18	6
D	25	5	6.5	16	8	5.5
E	25	5	6.5	26	18	6
F	25	5	9.5	22		

Drawings

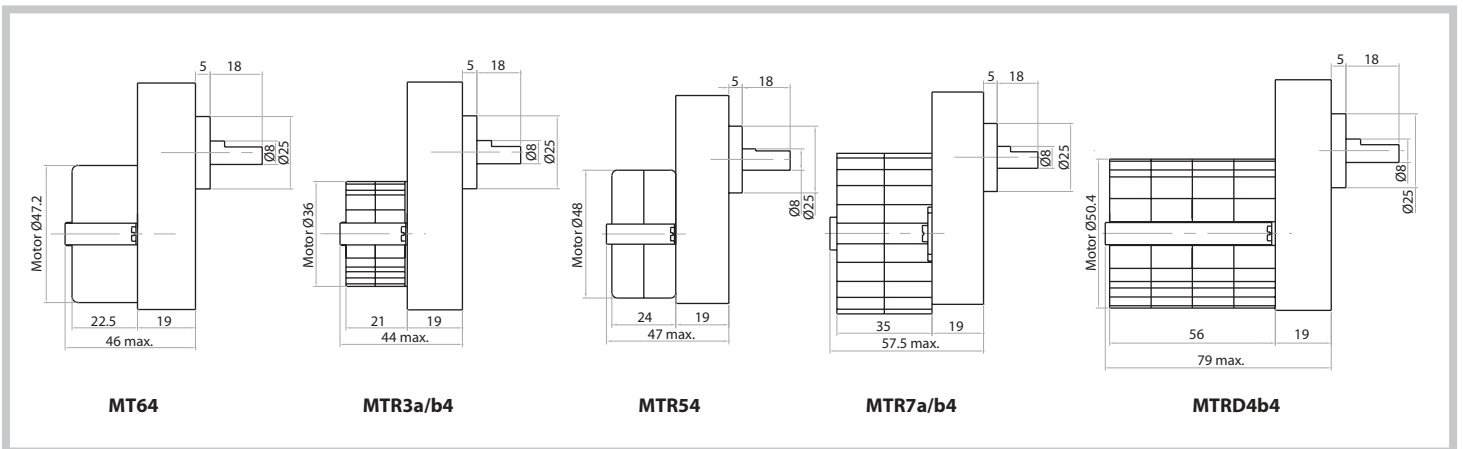

Photographs

