

Example of order: MAV SC2008-140 95 - 95

## Features

### MAV SC2008

- Rigid shaft-to-shaft coupling with sleeve and shrink discs MAV 2008 – standard duty
- Medium capacity
- Connection of shafts with different diameters is possible
- Shafts tolerance: see table for shrink discs
- Shafts surface finish  $R_a < 3.2 \mu\text{m}$
- Shafts – sleeve bore contact surfaces: grease-free and dry ( $\mu = 0.15$ )

### MAV SC2208

- Rigid shaft-to-shaft coupling with sleeve and shrink discs MAV 2208 – heavy duty
- High capacity
- Connection of shafts with different diameters is possible
- Shafts tolerance: see table for shrink discs
- Shafts surface finish  $R_a < 3.2 \mu\text{m}$
- Shafts – sleeve bore contact surfaces: grease-free and dry ( $\mu = 0.15$ )

## Composition

### MAV SC2008

- Two shrink discs MAV 2008
- Unslotted coupling sleeve

### MAV SC2208

- Two shrink discs MAV 2208
- Unslotted coupling sleeve

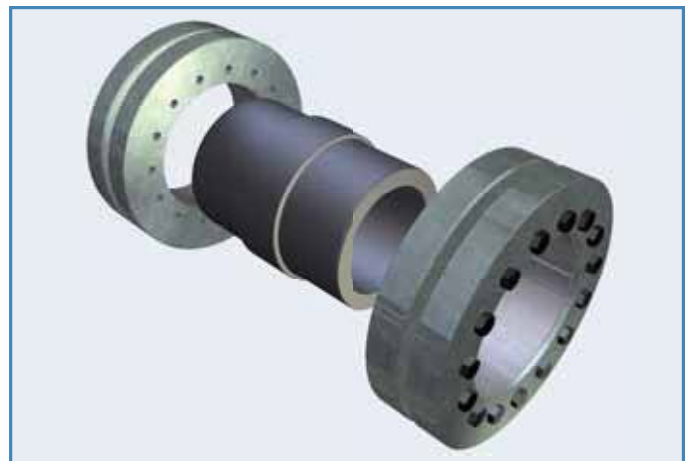

# MAV SC2208

## Heavy Sleeve couplings

measure	DIMENSIONS					SCREWS		FEATURES		WEIGHT kg
	ds mm	shrink disc MAV 2208 d x D	L mm	D1 mm	L1 mm	size	Ma Nm	Mt Nm	Fax kN	
125	85	125 x 215	200	136	74	M 12	100	20.100	470	32
	90							23.800	530	
	95							27.800	590	
140	95	140 x 230	210	148	82	M 12	100	21.500	450	39
	100							25.200	500	
	105							29.200	560	
155	105	155 x 263	230	170	88	M 12	100	31.100	590	58
	110							35.600	650	
	115							40.500	700	
165	115	165 x 290	240	177	98	M 16	250	48.300	840	74
	120							54.200	900	
	125							59.200	950	
175	125	175 x 300	250	187	98	M 16	250	53.200	850	78
	130							59.400	910	
	135							66.000	980	
185	135	185 x 330	265	201	122	M 16	250	92.900	1.400	117
	140							102.000	1.500	
	145							112.000	1.500	
195	145	195 x 350	280	216	122	M 16	250	103.000	1.400	131
	150							113.000	1.500	
	155							123.000	1.600	
200	145	200 x 350	290	216	122	M 16	250	99.000	1.400	135
	150							108.000	1.400	
	155							118.000	1.500	
220	160	220 x 370	310	236	144	M 16	250	148.000	1.900	173
	165							160.000	1.900	
	170							173.000	2.000	
240	170	240 x 405	350	254	157	M 20	490	181.000	2.100	228
	180							205.000	2.300	
	190							236.000	2.500	
260	190	260 x 430	390	274	173	M 20	490	252.000	2.700	278
	200							287.000	2.900	
	210							325.000	3.100	
280	210	280 x 460	430	296	185	M 20	490	323.000	3.100	340
	220							364.000	3.300	
	230							407.000	3.500	
300	230	300 x 485	445	316	189	M 20	490	365.000	3.200	380
	240							406.000	3.400	
	245							428.000	3.500	
320	240	320 x 520	460	336	197	M 20	490	450.000	3.700	465
	250							492.000	3.900	
	260							543.000	4.200	
340	250	340 x 570	480	356	215	M 24	840	544.000	4.400	619
	260							600.000	4.600	
	270							659.000	4.900	
350	270	350 x 580	490	366	215	M 24	840	667.000	4.900	621
	280							729.000	5.200	
	290							794.000	5.500	
360	280	360 x 590	500	376	219	M 24	840	661.000	4.700	640
	290							721.000	5.000	
	295							753.000	5.100	
390	300	390 x 660	540	405	227	M 24	840	850.000	5.700	862
	310							920.000	5.900	
	320							986.000	6.200	
420	330	420 x 690	580	435	253	M 24	840	1.210.000	7.300	1022
	340							1.300.000	7.600	
	350							1.390.000	7.900	
460	360	460 x 770	620	476	269	M 27	1250	1.650.000	9.100	1371
	370							1.760.000	9.500	
	380							1.870.000	9.800	
500	380	500 x 850	670	516	291	M 27	1250	1.890.000	10.000	1911
	390							2.010.000	10.000	
	400							2.140.000	11.000	

**Code:**

Ma: screws tightening torque

Mt: transmissible torque with

Fax=0 kN

Fax: transmissible axial load with

Mt=0 Nm