

## K30-TYPE

## Planetary GEARHEAD

### DIMENSIONS

#### K30-2847 SERIES

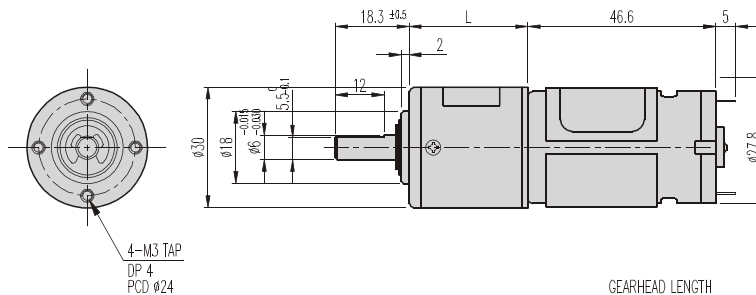

GEARHEAD LENGTH

RATIO	L
1/005	23.1
1/014 ~ 1/027	29.5
1/051 ~ 1/139	35.9
1/189 ~ 1/721	42.3

#### MOTOR PERFORMANCE DATA

ITEM MODEL	VOLTAGE (DC)	NO LOAD		AT MAX. EFF.			STALL		WEIGHT (g)
		mA	rpm	gf.cm	A	rpm	A	gf.cm	
ND1-2847-073	12V	170	7300	90	0,65	6300	5	830	110
ND2-2847-073	24V	90	7300	110	0,4	6300	2,8	870	

#### AT MAXIMUM EFFICIENCY (2847 SERIES)

MODEL GEAR	ND1-2847-073		ND2-2847-073	
	DC 12V		DC 24V	
	rpm	kgf.cm	rpm	kgf.cm
1/005	1260	0,4	1260	0,5
1/014	450	1	450	1,2
1/019	331	1,3	331	1,6
1/027	233	1,9	233	2,4
1/051	123	3	123	4
1/071	88	4,5	88	5,5
1/100	63	6,5	63	8
1/139	45	9	45	11
1/189	33	11	33	12
1/264	23	12	23	12
1/369	17	12	17	12
1/516	12	12	12	12
1/721	8,7	12	8,7	12

\* Gearbox output shaft rotation direction is same direction with motor.