

K22-TYPE

Planetary GEARHEAD

DIMENSIONS

K22-2419 BLDC SERIES

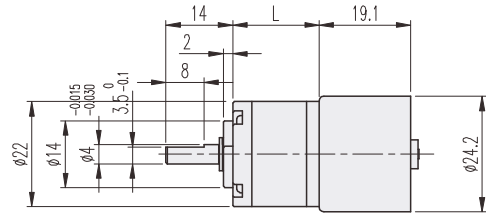
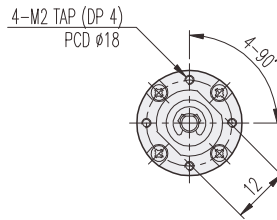

GEARHEAD LENGTH

RATIO	L	RATIO	L
1/4	14.4	1/198 ~ 1/455	25.35
1/14 ~ 1/19	18.05	1/742 ~ 1/1996	29
1/53 ~ 1/104	21.7		

BLDC MOTOR PERFORMANCE DATA

MODEL	ITEM	VOLTAGE (DC)	NO LOAD		AT MAX. EFF.		WEIGHT (g)	
			mA	rpm	gf-cm	mA		rpm
NB2419U1		12V	120	6200	25	200	4500	30
NB2419R2		24V	100	8700	18	180	7200	

AT MAXIMUM EFFICIENCY (BLDC 2419 SERIES)

GEAR	MODEL	NB2419U1		ND2419R2	
		DC 12V		DC 24V	
		rpm	kgf-cm	rpm	kgf-cm
1/4		1125	0.09	1800	0.06
1/14		321	0.29	514	0.2
1/16		281	0.33	450	0.23
1/19		237	0.39	379	0.27
1/53		85	1	136	0.68
1/62		73	1.1	116	0.8
1/72		63	1.3	100	0.93
1/84		54	1.6	86	1.1
1/104		43	1.9	69	1.3
1/198		22.7	3	36	2.3
1/231		19.5	3	31	2.7
1/270		16.7	3	26.7	3
1/316		14.2	3	22.8	3
1/370		12.1	3	19.5	3
1/455		9.9	3	15.8	3
1/742		6	3	9.7	3
1/1014		4.4	3	7.1	3
1/1249		3.6	3	5.7	3
1/1621		2.8	3	4.4	3
1/1996		2.3	3	3.6	3

* 출력축 회전방향은 MOTOR의 회전방향과 같습니다.