

K16-TYPE

Planetary GEARHEAD

DIMENSIONS

K16-1627 SERIES

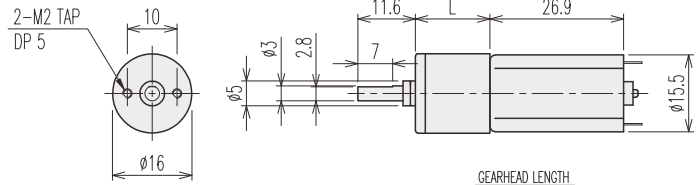

RATIO	L	RATIO	L
1/4	15	1/198 ~ 1/850	26.1
1/14 ~ 1/29	18.7	1/1014 ~ 1/4592	29.8
1/53 ~ 1/157	22.4		

MOTOR PERFORMANCE DATA

MODEL	ITEM	VOLTAGE (DC)	NO LOAD		AT MAX. EFF.			STALL		WEIGHT (g)
			mA	rpm	gf-cm	mA	rpm	mA	gf-cm	
ND1627R1		12V	90	8000	7	110	5900	300	32	16
ND1627M2		24V	60	13500	12	140	9200	360	47.6	

AT MAXIMUM EFFICIENCY (1627 SERIES)

GEAR	MODEL	ND1-1627-080		ND2-1627-135	
		DC 12V		DC 24V	
		rpm	kgf-cm	rpm	kgf-cm
1/4		1461	0.03	2110	0.04
1/14		417	0.07	600	0.12
1/16		365	0.09	528	0.14
1/19		307	0.1	444	0.16
1/29		201	0.15	291	0.25
1/53		110	0.23	159	0.37
1/62		94	0.27	136	0.43
1/72		81	0.31	117	0.49
1/84		69	0.36	100	0.58
1/104		56	0.45	81	0.72
1/128		45	0.55	66	0.88
1/157		37	0.68	53	1.08
1/198		29	0.69	42	1.1
1/231		25	0.81	36	1.3
1/270		21	0.94	31	1.5
1/316		18	1.1	26	1.7
1/370		15	1.3	22	2.1
1/455		13	1.6	18.5	2.5
1/561		10.4	1.96	15	3
1/690		8.5	2.4	12.2	3
1/850		6.9	2.9	9.9	3
1/1014		5.8	3	8.3	3
1/1249		4.7	3	6.7	3
1/1621		3.6	3	5.2	3
1/1996		2.9	3	4.2	3
1/2458		2.4	3	3.4	3
1/3027		1.9	3	2.8	3
1/3728		1.5	3	2.2	3
1/4592		1.2	3	1.8	3

* 출력축 회전방향은 MOTOR의 회전방향과 같습니다.