

SPEED CONTROL MOTOR - SU SERIES

90W

□90mm

REVERSIBLE MOTOR

K9RS90F□-SU

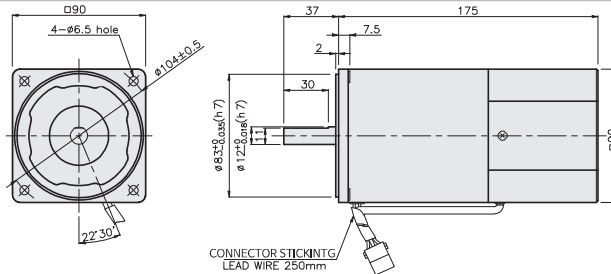

SPECIFICATIONS

90W 30 minutes rating, four poles

Model	Voltage (V)	Frequency (Hz)	Speed (rpm)	Permissible Torque		Start T. (N·m/kgf·cm)	Current (A)	Condenser (μF)		
				1200rpm (N·m/kgf·cm)	90rpm (N·m/kgf·cm)					
K9R□90FJ-SU	100	50	90 ~ 1400	0.25/2.5	0.25/2.5	0.4/4	3.6	35		
		60	90 ~ 1700				3.4			
K9R□90FU-SU	110	60	90 ~ 1700			0.38/3.8	3	25		
	115						3.2			
K9R□90FL-SU	200	50	90 ~ 1400			0.75/7.5	0.25/2.5	0.4/4	1.4	8
		60	90 ~ 1700						1.5	
K9R□90FC-SU	220	50	90 ~ 1400			0.43/4.3	0.25/2.5	0.43/4.3	1.2	7
		60	90 ~ 1700						1.4	
	230	50	90 ~ 1400						1.2	
		60	90 ~ 1700						1.4	
K9R□90FD-SU	240	50	90 ~ 1400	0.25/2.5	0.4/4	1.3	6			

※ □ : SHAFT SHAPE (S : STRAIGHT, P : PINION)

RATED TORQUE OF GEARHEAD

● Single-phase 100V/115V

unit = above : N·m / below : kgf·cm

Model	Ratio	3	3.6	5	6	7.5	9	10	12.5	15	18	20	25	30	36	40	50	60	75	90	100	120	150	180	200
K9R□90F□-SU K9P□B, BF	1200	1.82	2.04	3.04	3.65	4.56	5.47	6.08	6.83	8.20	9.84	10.94	12.30	14.76	17.71	19.68	20	20	20	20	20	20	20	20	20
	90	0.61	0.73	1.01	1.22	1.52	1.82	2.03	2.28	2.73	3.28	3.65	4.10	4.92	5.90	6.56	8.20	9.84	11.07	13.29	14.76	17.71	20	20	20

● Single-phase 200V/240V

unit = above : N·m / below : kgf·cm

Model	Ratio	3	3.6	5	6	7.5	9	10	12.5	15	18	20	25	30	36	40	50	60	75	90	100	120	150	180	200	
K9R□90F□-SU K9P□B, BF	1200	1.82	2.19	3.04	3.65	4.56	5.47	6.08	6.83	8.20	9.84	10.94	12.30	14.76	17.71	19.68	20	20	20	20	20	20	20	20	20	
	90	200V/220V 230V/240V 50Hz	0.61	0.73	1.01	1.22	1.52	1.82	2.03	2.28	2.73	3.28	3.65	4.10	4.92	5.90	6.56	8.20	9.84	11.07	13.29	14.76	17.71	20	20	20
		200V/220V 230V/60Hz	0.68	0.82	1.13	1.36	1.70	2.04	2.27	2.55	3.06	3.67	4.08	4.59	5.51	6.61	7.35	9.19	11.02	12.40	14.88	16.53	19.84	20	20	20

- * Gearhead and decimal gearhead are sold separately.
- * The code in □ of gearhead model is for gear ratio.
- * color indicates that the output shaft of the geared motor rotates in the same direction as the output shaft of the motor. Others indicate rotation in the opposite direction.
- * If you are to have less ratio than the ratio in the table, you can install the decimal gearhead, which has one tenth of the ratio, between the gearhead and the motor. In this case, the permissible torque is 3N·m/30kgf·cm.
- * RPM is based on motor's synchronous rpm (50HZ:1500rpm, 60HZ:1800rpm) and calculated by dividing gear ratio, Actual rpm is 2~20% less than indicating rpm according to load size.

GEARHEAD

RATED TORQUE OF GEARHEAD

● Single-phase 100V/115V

unit = above : N·m / below : kgf·cm

Model	Ratio																								
Motor/Gearhead	Speed(rpm)	3	3.6	5	6	7.5	9	10	12.5	15	18	20	25	30	36	40	50	60	75	90	100	120	150	180	200
K9R□90F□-SU K9P□BU, BUF	1200	1.82	2.19	3.04	3.65	4.56	5.47	6.08	6.83	8.20	9.84	10.94	12.30	14.76	17.71	19.68	24.60	29.52	30	30	30	30	30	30	30
	90	0.61	0.73	1.01	1.22	1.52	1.82	2.03	2.28	2.73	3.28	3.65	4.10	4.92	5.90	6.56	8.20	9.84	11.07	13.29	14.76	17.71	22.14	26.57	29.52
		6.1	7.3	10.1	12.2	15.2	18.2	20.3	22.8	27.3	32.8	36.5	41.0	49.2	59.0	65.6	82.0	98.4	110.7	132.9	147.6	177.1	221.4	265.7	295.2

● Single-phase 200V/240V

unit = above : N·m / below : kgf·cm

Model	Ratio																									
Motor/Gearhead	Speed(rpm)	3	3.6	5	6	7.5	9	10	12.5	15	18	20	25	30	36	40	50	60	75	90	100	120	150	180	200	
K9R□90F□-SU K9P□BU, BUF	1200	1.82	2.19	3.04	3.65	4.56	5.47	6.08	6.83	8.20	9.84	10.94	12.30	14.76	17.71	19.68	24.60	29.52	30	30	30	30	30	30	30	
	90	200V/220V 230V/240V 50Hz	0.61	0.73	1.01	1.22	1.52	1.82	2.03	2.28	2.73	3.28	3.65	4.10	4.92	5.90	6.56	8.20	9.84	11.07	13.29	14.76	17.71	22.14	26.57	29.52
		200V/220V 230V/60Hz	0.68	0.82	1.13	1.36	1.70	2.04	2.27	2.55	3.06	3.67	4.08	4.59	5.51	6.61	7.35	9.19	11.02	12.40	14.88	16.53	19.84	24.80	29.76	30
			6.8	8.2	11.3	13.6	17.0	20.4	22.7	25.5	30.6	36.7	40.8	45.9	55.1	66.1	73.5	91.9	110.2	124.0	148.8	165.3	198.4	248.0	297.6	300

- * Gearhead and decimal gearhead are sold separately.
- * The code in □ of gearhead model is for gear ratio.
- * color indicates that the output shaft of the geared motor rotates in the same direction as the output shaft of the motor, Others indicate rotation in the opposite direction.
- * If you are to have less ratio than the ratio in the table, you can install the decimal gearhead, which has one tenth of the ratio, between the gearhead and the motor. In this case, the permissible torque is 3N·m/30kgf·cm.
- * RPM is based on motor's synchronous rpm (50Hz:1500rpm, 60Hz:1800rpm) and calculated by dividing gear ratio. Actual rpm is 2~20% less than indicating rpm according to load size.

CONNECTION DIAGRAMS

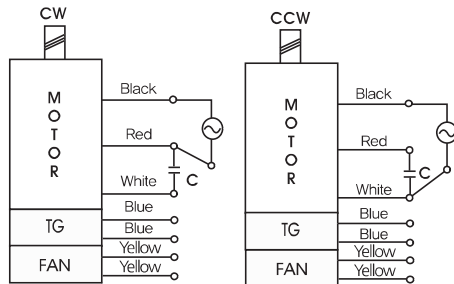

※The direction of motor rotation is as viewed from the front shaft end of the motor

GEARHEAD

DIMENSIONS

K9P□B



K9P□BF, BUF



K9P□BU



DECIMAL GEARHEAD

K9P10BX

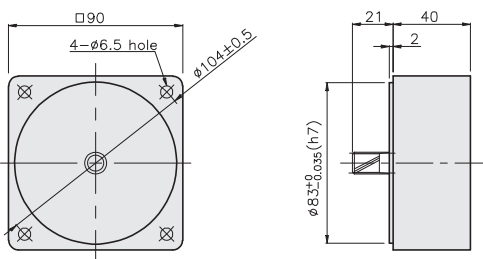

KEY SPEC

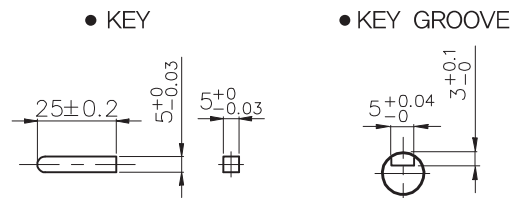

GEARHEAD

K9P□B

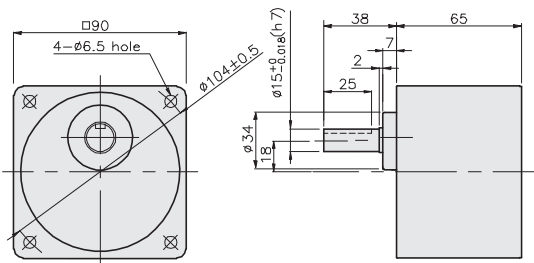

K9P□BF

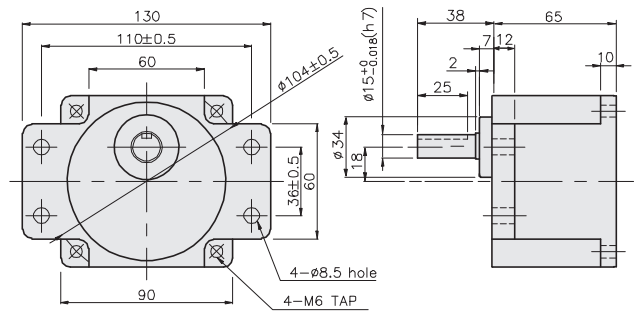

K9P□BU

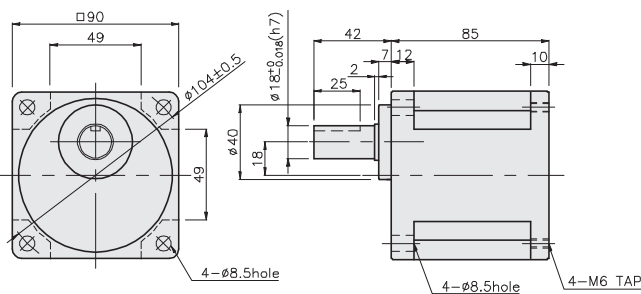

K9P□BUF

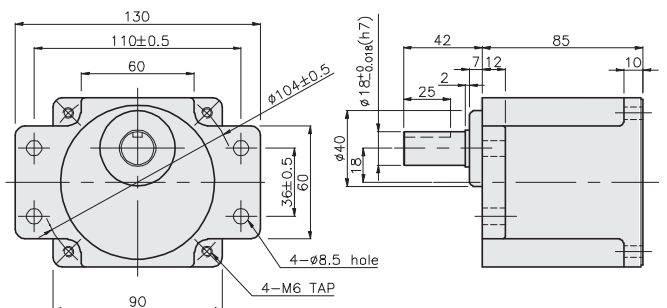

GEARHEAD

DIMENSIONS

K9RP90F□-SU + K9P□B



K9RP90F□-SU + K9P□BF, BUF



K9RP90F□-SU + K9P□BU



K9RP90F□-SU + K9P□B

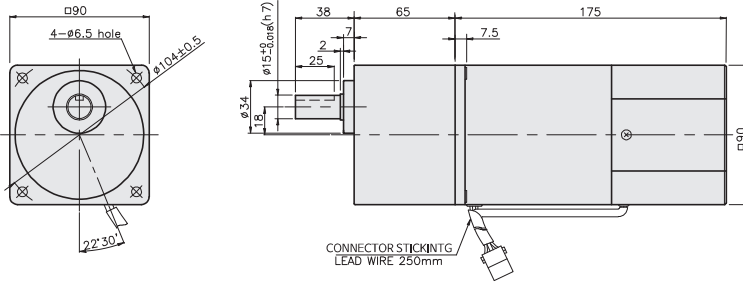

WEIGHT

PART	WEIGHT(kg)
MOTOR	3.06
DECIMAL GEARHEAD	0.62

DIMENSION TABLE

PART No.	Application Model	Mounting BOLT
01	K9P3~200B	M6 P1.0 × 95
02	K9P10BX	M6 P1.0 × 140

WEIGHT

PART	WEIGHT(kg)
K9P3~10B	1.22
K9P12.5~20B	1.32
K9P25~60B	1.42
K9P75~200B	1.45

K9RP90F□-SU + K9P□BF

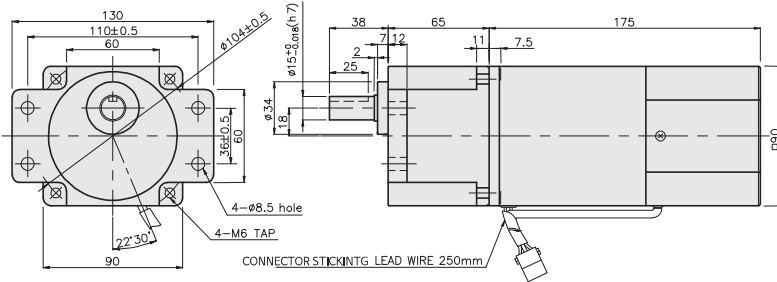

DIMENSION TABLE

PART No.	Application Model	Mounting BOLT
01	K9P3~200BF	M6 P1.0 × 20
02	K9P10BX	M6 P1.0 × 65

WEIGHT

PART	WEIGHT(kg)
K9P3~10BF	1.22
K9P12.5~20BF	1.30
K9P25~60BF	1.42
K9P75~200BF	1.44

K9RP90F□-SU + K9P□BU

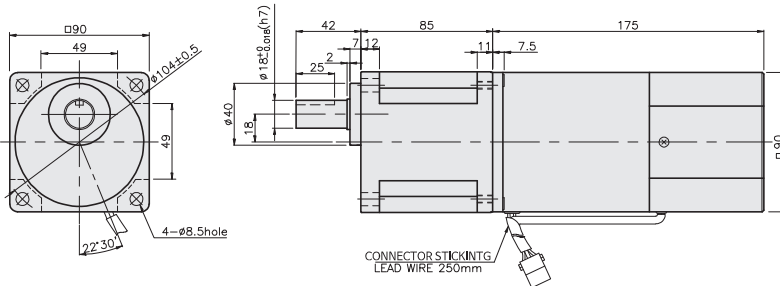

DIMENSION TABLE

PART No.	Application Model	Mounting BOLT
01	K9P3~200BU	M6 P1.0 × 20
02	K9P10BX	M6 P1.0 × 65

WEIGHT

PART	WEIGHT(kg)
K9P3~10BU	1.44
K9P12.5~20BU	1.55
K9P25~60BU	1.69
K9P75~200BU	1.74

K9RP90F□-SU + K9P□BUF

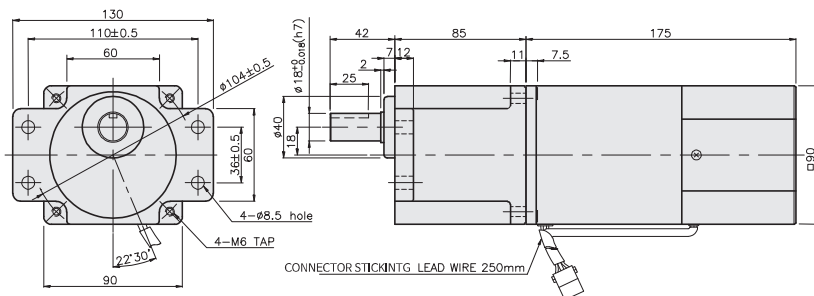

DIMENSION TABLE

PART No.	Application Model	Mounting BOLT
01	K9P3~200BUF	M6 P1.0 × 20
02	K9P10BX	M6 P1.0 × 65

WEIGHT

PART	WEIGHT(kg)
K9P3~10BUF	1.50
K9P12.5~20BUF	1.62
K9P25~60BUF	1.76
K9P75~200BUF	1.82