

# MT23FK / 1,8°

• General characteristics



Step accuracy	±5%
Temperature rise	80° C max @ nominal current
Ambient temperature	-20° C ~ +50° C
Insulation resistance	100Mohm min. 500Vdc.
Dielectric strength	500Vac 1 minute
Insulation class	B, 120° C
Protection	IP30
Max radial force	75 N
Max axial force	15 N
Shaft radial play	0.02 max 450 g. load
Shaft axial play	0.08 max 450 g. load

• Specifications

Model Code	Rated Voltage (V)	Phase Current (A)	Phase Resistance (ohm)	Phase Inductance (mH)	Holding Torque (Nm)	Detent Torque (Nm)	Rotor Inertia (g.cm <sup>2</sup> )	Wires	Motor Length (mm)	Weight (Kg)	Special (see pag.4)
MT23FK17028M4	2.00	2.80	0.70	1.40	0.539	0.021	120	4	41.0	0.37	---
MT23FK20021B4	2.94	2.10	1.40	3.90	0.980	0.036	275	4	51.0	0.50	double shaft, 19.0 mm and Ø 6.35 mm
MT23FK22010M8G1	6.60	1.00	6.60	8.20	5.890*	0.040	275	8	51.0	0.65	with gearbox 1:11 enclosed (length +32 mm)
MT23FK22033M8	2.27	3.30	0.69	1.20	1.269	0.040	300	8	56.0	0.70	---
MT23FK30028M4	3.20	2.80	1.13	3.60	1.890	0.068	480	4	76.0	1.00	---
MT23FK30030B4	2.58	3.00	1.00	4.00	1.890	0.068	480	4	76.0	1.00	double shaft 15.0 mm and Ø 6.35 mm
MT23FK30042M401	2.10	4.20	0.50	1.60	1.890	0.068	480	4	76.0	1.00	guaina sui cavi

\* Measured torque at the gearbox output

• Dimensions (Unit: mm)

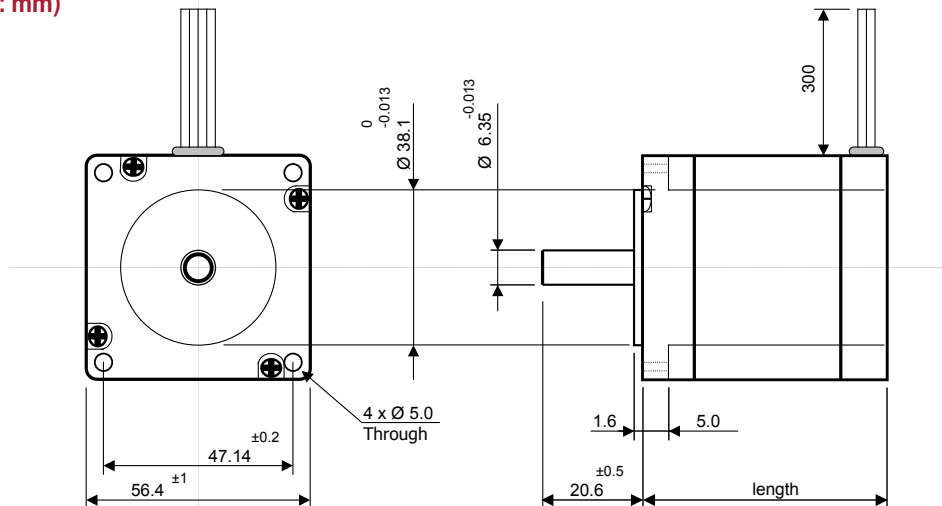

• Wiring diagrams

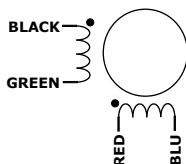

PHASE	A	A/	B	B/
LEAD COLOR	BLACK	GREEN	RED	BLU

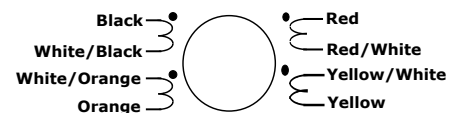

• Torque curves

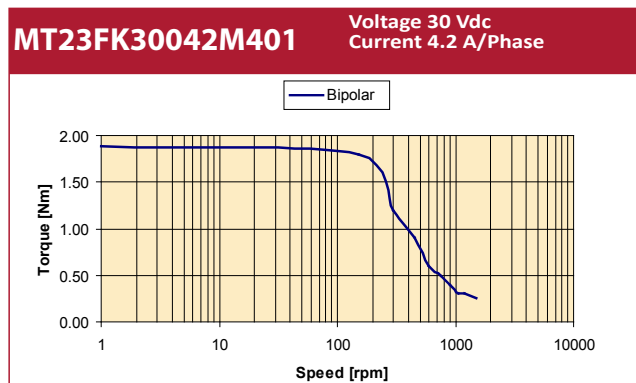
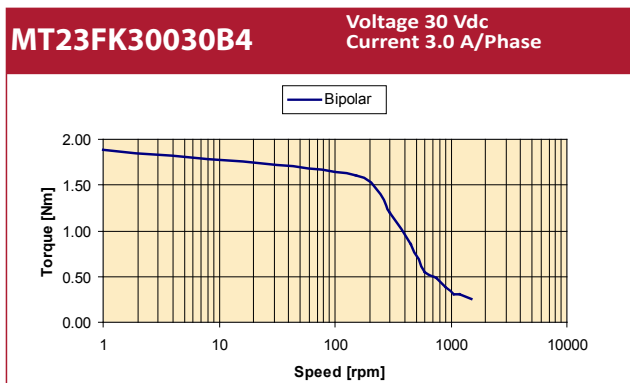
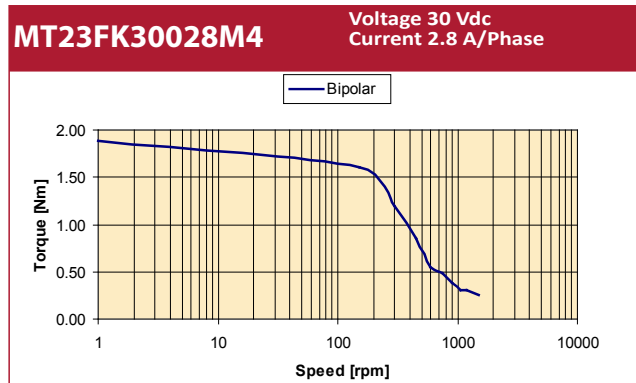
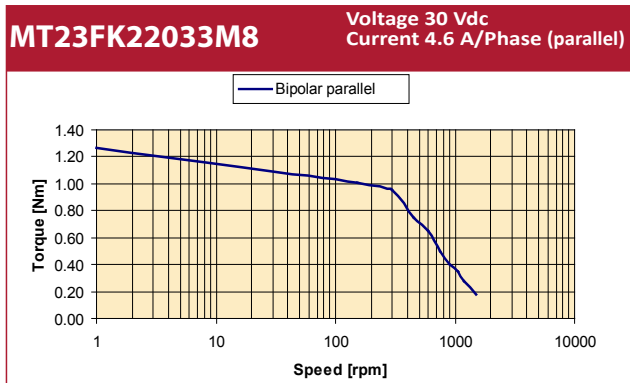
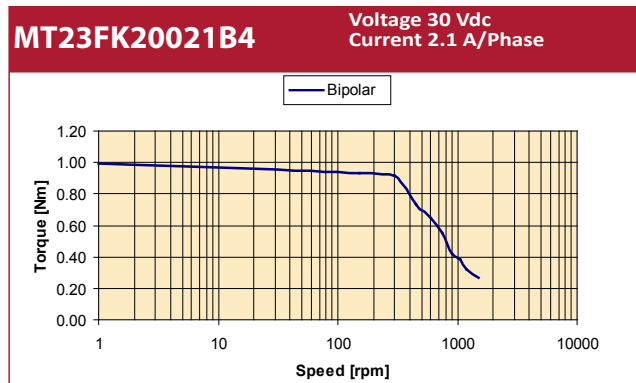
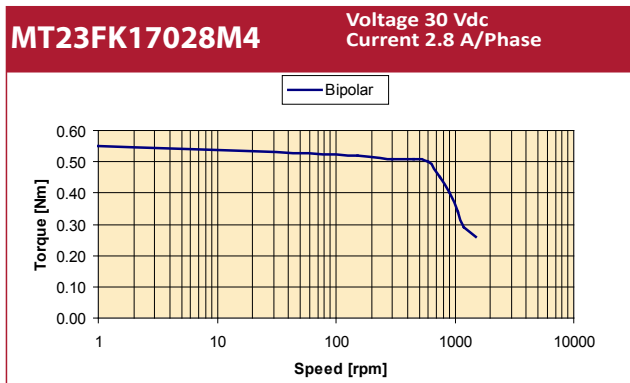

- Quality of motors, coding table and usage
- 2 phases hybrid step motors NEMA 10 (25 mm)
- 2 phases hybrid step motors NEMA 12 (28 mm) NEMA 14 (35 mm)
- 2 phases hybrid step motors NEMA 17 (42 mm)
- 2 phases hybrid step motors NEMA 23 (57 mm)
- 2 phases hybrid step motors NEMA 24 (60 mm)
- 2 phases hybrid step motors NEMA 34 (86 mm)
- 2 phases hybrid step motors NEMA 42 (110 mm)
- 2 phases permanent magnet step motors NEMA 08 (15 mm) NEMA 12 (25 mm)
- 2 phases permanent magnet step motors NEMA 12 (25 mm) NEMA 14 (35 mm)
- 2 phases permanent magnet step motors NEMA 17 (42 mm)
- DC brushless motors NEMA 17 (42 mm) NEMA 23 (57 mm)
- DC brushless motors with integrated driver NEMA 17 (42 mm) NEMA 23 (57 mm)
- Encoders
- Planetary gearboxes
- Company and contacts