

Features

- Connection of outer hollow shaft onto inner shaft
- Transmissible torque from 87 to 26.403 Nm
- Low self-locking tapers
- Two-part design
- Lubrication: food grade paste FDA approved class H-1
- Outer hollow shaft bore – inner shaft contact surface lubricant-free and dry
- Tolerance of outer hollow shaft outer diameter: h8 or f7
- Outer hollow shaft – inner shaft clearance:
 - max values according to table
 - min value 0.017 mm, to prevent installation issues
- Outer hollow shaft – inner shaft surface finish $0.8 \leq Ra \leq 3.2 \mu\text{m}$

Composition

- Slotted inner ring, with integrated push-off tapped holes
- Outer ring
- Set of hexagonal head cap screws, grade A2-70

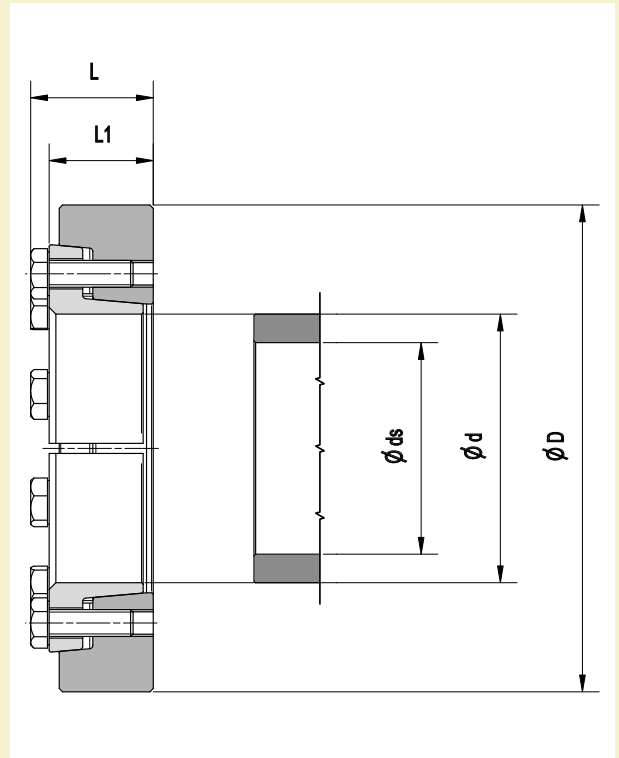

DIMENSIONS				SCREWS		PERFORMANCES				WEIGHT kg
ds mm	d x D mm	L mm	L1 mm	size	Ma Nm	Mt Nm	Fax kN	Ps MPa	Ph MPa	
15	18 x 44	19,0	15	M6	6,8	87	11,6	59	150	0,14
16						154	19,3	91	150	
17	20 x 47	19,0	15	M6	6,8	118	13,9	62	135	0,15
18						188	20,8	88	135	
19						113	11,9	41	128	0,20
20	24 x 50	22,0	18	M6	6,8	185	18,5	60	128	
21						267	25,4	79	128	
24						230	19,2	45	112	
25	30 x 60	24,0	20	M6	6,8	318	25,4	58	112	0,31
26						414	31,9	70	112	
28						451	32,2	58	121	0,49
30	36 x 72	27,3	22	M8	16	674	44,9	76	121	
31						627	40,5	66	121	
34						420	24,7	33	112	
35	44 x 80	29,3	24	M8	16	566	32,4	42	112	0,62
36						723	40,2	51	112	
38						896	47,2	51	125	0,83
40	50 x 90	31,3	26	M8	16	1.264	63,2	65	125	
42						1.675	79,8	79	125	
42						1.303	62,1	58	124	
45	55 x 100	34,3	29	M8	16	1.934	85,9	76	124	1,2
48						2.660	110,8	91	124	
48						1.599	66,6	55	110	1,4
50	62 x 110	34,3	29	M8	16	2.018	80,7	64	110	
52						2.026	77,9	59	110	

Code

- Ma: screws tightening torque
- Mt: transmissible torque, with Fax=0 kN
- Fax: transmissible axial load, with Mt=0 Nm
- Ps: contact pressure on inner shaft
- Ph: contact pressure on outer hollow shaft

Listed performances are valid as long as outer hollow shaft and inner shaft are made of stainless steel. Should these parts be made of different materials, listed values might not apply.

As long as inner shaft is made of standard steel and outer hollow shaft is made of stainless steel, Mt and Fax will be derated to 57.14% of listed values.

Please consult MAV Technical Dept. for advise.

Information subject to change without prior notification, © MAV S.p.A.

Stainless steel series AISI 400

shaft - hollow shaft fitting tolerances			
shaft size ds (mm)		ISO tolerances	max clearance mm
from	to		
11	18	n/a	0,017
19	30	H6 - j6	0,032
31	50	H6 - h6	0,048
51	80	H6 - g6	0,069
81	120	H7 - g6	0,079
121	180		

DIMENSIONS				SCREWS		PERFORMANCES				WEIGHT kg
ds mm	d x D mm	L mm	L1 mm	size	Ma Nm	Mt Nm	Fax kN	Ps MPa	Ph MPa	
50						1.648	65,9	52	113	
55	68 x 115	34,3	29	M8	16	2.176	79,1	57	113	1,4
60						3.645	121,5	80	113	
55						322	11,7	8	83	
60	75 x 138	37,4	31	M10	32	1.444	48,1	29	83	2,3
65						2.821	86,8	49	83	
60						618	20,6	12	78	
65	80 x 145	37,4	31	M10	32	1.795	55,2	31	78	2,5
70						3.212	91,8	48	78	
65						1.028	31,6	15	80	
70	90 x 155	44,4	38	M10	32	2.431	69,4	30	80	3,4
75						4.090	109,1	44	80	
70						1.567	44,8	17	82	
75	100 x 170	49,4	43	M10	32	3.162	84,3	30	82	4,7
80						5.021	125,5	42	82	
75						2.568	68,5	21	85	
80	110 x 185	56,5	49	M12	55	4.449	111,2	32	85	6,2
85						4.394	103,4	28	85	
80						4.040	101,0	27	85	
85	115 x 197	60,5	53	M12	55	3.531	83,1	21	85	7,6
90						6.263	139,2	33	85	
85						1.895	44,6	11	81	
90	120 x 197	60,5	53	M12	55	4.361	96,9	23	81	7,3
95						7.179	151,1	34	81	
85						1.878	44,2	11	87	
90	125 x 215	60,5	53	M12	55	4.281	95,1	23	87	9,2
95						7.022	147,8	34	87	
85						503	11,8	3	83	
90	130 x 215	60,5	53	M12	55	2.685	59,7	14	83	8,8
95						5.184	109,1	25	83	
90						1.392	30,9	7	81	
95	135 x 230	66,8	58	M14	89	3.894	82,0	17	81	11
100						6.733	134,7	27	81	
95						2.240	47,2	10	78	
100	140 x 230	66,8	58	M14	89	4.843	96,9	19	78	11
105						7.775	148,1	28	78	
105						5.790	110,3	19	81	
110	155 x 263	70,8	62	M14	89	8.901	161,8	27	81	16
115						12.349	214,8	34	81	
115						12.140	211,1	30	83	
120	165 x 290	78,0	68	M16	135	16.110	268,5	36	83	22
125						18.094	289,5	38	83	
125						16.719	267,5	35	87	
130	175 x 300	78,0	68	M16	135	21.363	328,7	41	87	23
135						26.403	391,2	47	87	

