

Type SDF – Horizontal working position

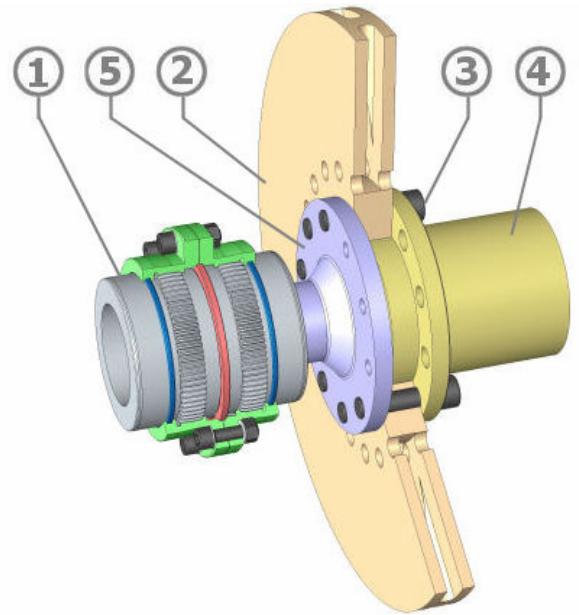
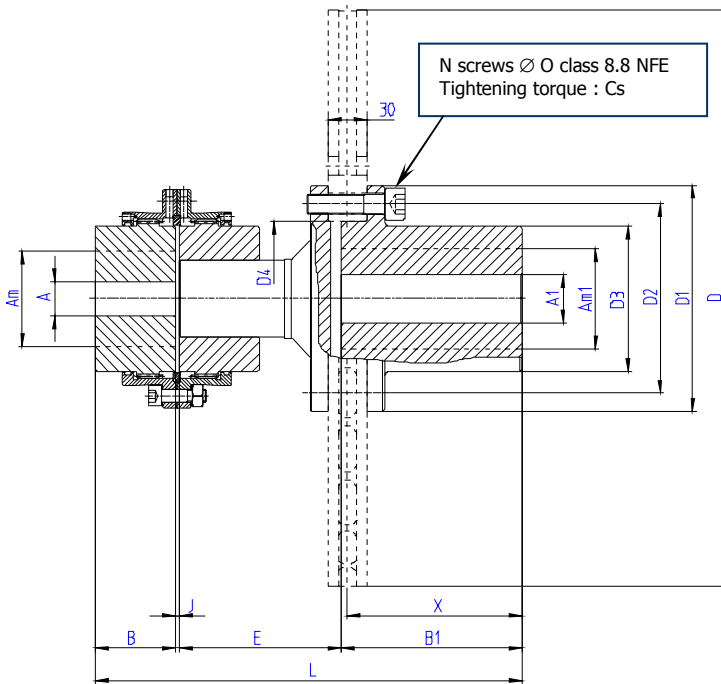

Item	Designation
1	Coupling Senior S
2	Brake disc
3	Screws & Bolts
4	Solid hub
5	Spacer

Π : max speed allowed by the disc according the manufacturer. For higher speed, please consult us.

DISC AND SOLID HUB													
D	Π Min ⁻¹	A1	Am1*	Am1**	B1	D1	D2	D3	D4	N	O	Cs Nm	X
315	3000	/	55	50	107	124	105	82	85	9	M10	49	102
355	2700	/	70	60	107	145	125	100	105	9	M12	86	102
395	2400	/	75	70	107	165	140	112	115	9	M14	135	102
445	2100	/	80	70	140	175	146	112	120	12	M16	210	135
495	1900	30	110	100	140	218	190	155	160	12	M18	290	135
550	1800	30	110	100	140	218	190	155	160	12	M18	290	135
625	1500	30	120	105	140	238	205	168	170	12	M20	410	135
705	1300	30	135	120	140	268	230	190	195	12	M22	550	135
795	1200	30	150	135	140	300	260	216	220	12	M24	710	135

Example of designation: **S80 DF 550**
SENIOR coupling size **80** with a **550** diameter brake disc.

SIZE		68				80				100				115				135				150				170	
Disc diameter		315	355	395	445	395	445	495	550	445	495	550	625	495	550	625	705	625	705	795	625	705	795	705	795	705	795
Peak torque Max	Nm	1500	2200	2200	2200	2200	3800	3800	3800	6000	6000	6000	6000	9400	9400	9400	9400	13800	13800	13800	20700	25300	25300	29200	36700		
Rough bore	A	18				26				35				35				58				68				83	
Max Bore	Am*	68				80				100				115				135				150				170	
	Am**	63				75				92				106				125				140				160	
	B	50				62				76				90				105				120				135	
	J	3				3				5				5				6				6				8	
	E	117	117	117	117	117	130	145	145	145	164	164	164	180	180	180	180	196	196	196	223	223	223	238	238	238	238
	L	274	274	274	307	286	332	347	347	361	380	380	380	410	410	410	410	441	441	441	483	483	483	513	513	513	513
Weight •	Kg	15	18	20.5	24	26	30	45	45	40	56	56	63	71	71	77	87	99	110	123	127	137	150	173	185	173	185
Moment of Inertia J •	Kgm ²	0.02	0.03	0.04	0.05	0.06	0.07	0.16	0.16	0.12	0.21	0.21	0.27	0.3	0.3	0.36	0.48	0.559	0.68	0.862	0.846	0.965	1.148	1.463	1.642	1.463	1.642
Weight of grease	Kg	0.08				0.12				0.26				0.38				0.60				0.80				1	

- * Bore with keyway according ISO R 773 or DIN 6885/1 standard
- ** Shrink fitting
- Solid hubs
- y Dynamically balanced
- ∇ Per coupling

Check that the max peak torque of the coupling is higher than the peak torque of the installation