

Serie Light

SR335L/LI/LE Nylon Cable Chain

Inner height (D) 35 mm

Single link construction with central large anti-friction pivot, for high torsion and tensile resistance.

Non-openable version (SR335L).

Version with openable frames from inner radius (SR335LI) or from outer radius (SR335LE).

Vertical separators available.

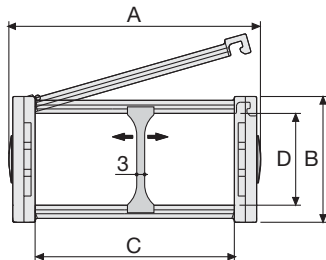

Separator

- Unassembled	Part.no S4353
- Assembled	Part.no S4353MC

Technical characteristics when self-supported

Speed	10 m/s
Acceleration	50 m/s ²

For higher requirements please consult our technical dept.

For sliding applications, technical data can slightly change according to frequency, added weight and environment.

A	B	C	D	R	Weight/m	Chain
mm	mm	mm	mm	mm	kg	Part Number
56,5	50	40	35	065-075-100-125-150-200	1,12	SR335L(LI)(LE)040□□□*
66,5	50	50	35	065-075-100-125-150-200	1,15	SR335L(LI)(LE)050□□□*
76,5	50	60	35	065-075-100-125-150-200	1,19	SR335L(LI)(LE)060□□□*
92,5	50	76	35	065-075-100-125-150-200	1,25	SR335L(LI)(LE)076□□□*
119,5	50	103	35	065-075-100-125-150-200	1,36	SR335L(LI)(LE)103□□□*
141,5	50	125	35	065-075-100-125-150-200	1,44	SR335L(LI)(LE)125□□□*
166,5	50	150	35	065-075-100-125-150-200	1,54	SR335L(LI)(LE)150□□□*

*Complete the code by inserting the value of the radius (R): Ex. SR335L(LI)(LE)040 □ □ □ □

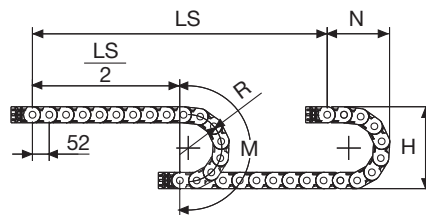

R	H	N	M	N1	M1
mm	mm	mm	mm	mm	mm
065	180	169	310	165	345
075	200	179	340	190	420
100	250	204	420	230	530
125	300	229	500	320	750
150	350	254	580	405	970
200	450	304	735	580	1405

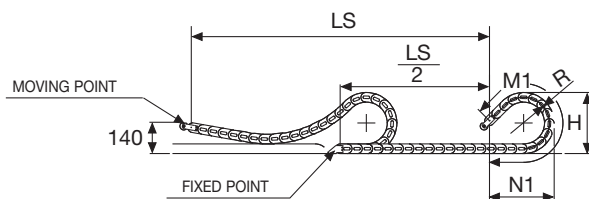

Length of chain (L)
Half travel distance ($\frac{LS}{2}$)
plus length of curve (M) or (M1)

$$L = \frac{LS}{2} + M \text{ or } M1$$

SR335L

Non-openable



SR335LI

Frames openable from inner radius



SR335LE

Frames openable from outer radius



Self-Supporting Capacity Diagram

The maximum length of the self-supporting capacity ($\frac{LS}{2}$) in relationship to the weight of the cables and hoses contained per linear metre.

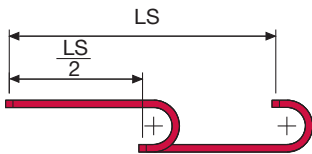
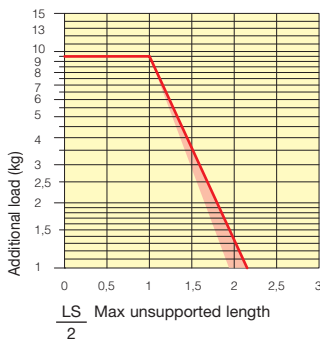

The red marking in the diagram area considers the difference of weight between various widths of chain.

For applications with $\frac{LS}{2}$ and weights not included in the area of the diagram showing self-supporting capacity, verify the possible use of support rollers (see page 30).

End Brackets

The end brackets set allows the two ends of the chain to be attached to the equipment. Set complete with tiewrap clamps available on request.

Nylon Type

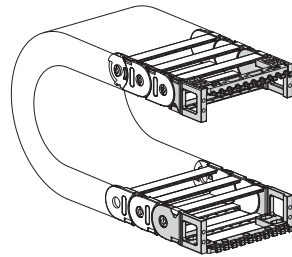
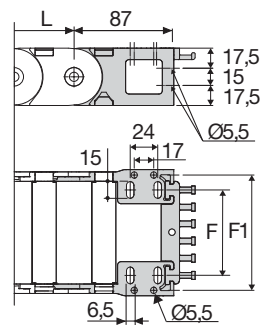

Fig. A
Fissaggio della catena frontale, esterno/interno raggio. (Fig A)



Chain type	F mm	F1 mm
SR335L...040	25	51
SR335L...050	35	61
SR335L...060	45	71
SR335L...076	61	87
SR335L...103	88	114
SR335L...125	110	136
SR335L...150	135	161

Nylon Type Part Numbers

Chain Type	End Brackets Set
SR335	AN335L□□□*KM□**

Chain Type	End Brackets Set
SR335	AN335L□□□*K

Tiewrap Clamp	Part Number
SR335	PFN335□□□*

* Inner width (C)

** 1=Pos.1; 2=Pos.2; 3=Pos.3

Serie Light

SR335L

SR335LI

SR335LE

Nylon Cable Chain

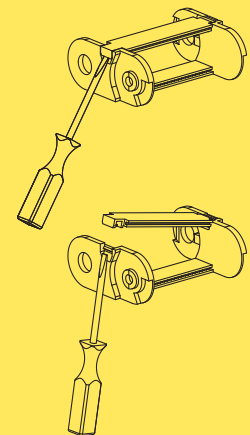

How to open the cover.

For further information please consult Brevetti Stendalto's Technical Office